

# HP LaserJet 5200 printer series

Designed to deliver efficiency and versatility, the HP LaserJet 5200 printer series is an ultra-powerful, wide-format/A3+ laser printer built with flexibility and easy manageability to meet the needs of business workteams.

## HP LaserJet 5200 printer series

### Technical specifications

<b>Product certifications</b>	
Safety certifications:	Argentina (TUV S Mark-Rs.92/98/Ds.1009/98), Australia (AS/NZ 3260), Canada (cUL-CAN/CSA C22.2 No.60950-1-03), China (GB4943), EU (CE Mark-Low Voltage Directive 73/23/EEC), Germany (TUV-EN60950-1, IEC 60825-1), Mexico (NOM NYCE-NOM 019 SCFI), Russia (GOST-R50377), South Africa (IEC 60950-1, IEC60825 1), USA (UL-UL 60950-1; FDA-21 CFR Chapter 1 Subchapter J for lasers); Class 1 Laser/LED Product
EMC certifications:	CISPR 22: 1993/A1, A2; EN 55022: 1994/A1, A2 Class B; EN 61000-3-2: 2000; EN 61000-3-3: 1995/A1; EN 55024: 1998/A1, A2; FCC Title 47 CFR, Part 15 Class B/ICES-003, Issue 4/GB9254-1998, GB17625.1-2003; EMC Directive 89/336/EEC, the Low Voltage Directive 73/23/EEC, and carries the CE-Marking accordingly
<b>Warranty</b>	One-year, return to HP limited warranty

For more information, call your local Hewlett-Packard sales office or your nearest HP authorised dealer:

HP customer information centre (for product information)	
Australia	13 23 47
China	800 820 2255
Hong Kong	800 938 833
India	3030 4499
Indonesia	0800 1111 222
Korea	080 703 0700
Malaysia	1800 88 4848
New Zealand	0800 733 547
Philippines	1800 1441 6688
Singapore	1800 278 8100
Taiwan	0800 236 686
Thailand	+662 353 9000
Vietnam	+848 823 6215

For the following countries, please fax your queries to: +65 6 275 6707  
• Bangladesh • Brunei • Cambodia • Pakistan • Sri Lanka

HP customer care centre (for post-sales service)	
Australia	13 10 47
China	800 810 5959
Hong Kong	+852 3002 8555
India	1600 112 267
Indonesia	+62 21 350 3408
Korea	+82 2 3270 0700
Malaysia	1800 80 5405
New Zealand	0800 449 553
Philippines	+63 2 867 3551
Singapore	+65 6 272 5300
Taiwan	+886 2 8722 8000
Thailand	+662 353 9000
Vietnam	+848 823 4530

For more information on HP Care Pack, visit: <http://www.hp.com/apac/hpservices/carepack>  
HP Instant Support Professional Edition (ISPE), visit: <http://instandsupport.asiapac.hp.com>  
For more information on support, visit: <http://www.hp.com/support>  
For more information on HP genuine parts, visit: <http://www.hp.com/go/hpparts>  
For specific warranty details, please check with your local country resellers.



Energy Star is a U.S. registered mark of the United States Environmental Protection Agency. Windows and Windows XP are U.S. registered trademarks of Microsoft Corporation. PostScript is a trademark of Adobe Systems Incorporated.

© 2006 Hewlett-Packard Development Company, L.P.  
The information contained herein is subject to change without notice. The only warranties for HP products and services are set forth in the express warranty statements accompanying such products and services. Nothing herein should be construed as constituting an additional warranty. HP shall not be liable for technical or editorial errors or omissions contained herein.

Printed in Singapore, 2001-7905-EEP, April 2006

### Ordering information

Number	Description
Q7543A	HP LaserJet 5200 Printer
Q7544A	HP LaserJet 5200n Printer
Q7545A	HP LaserJet 5200tn Printer
Q7546A	HP LaserJet 5200dn Printer

#### Paper handling

Q7549A	Automatic two-sided printing unit
Q7548A	500-sheet input tray

#### Supplies

Q7516A	HP LaserJet Black Print Cartridge with Smart Printing Technology. Average cartridge yield 12,000 standard pages*
--------	---

\* Declared yield value in accordance with ISO/IEC 19752.

#### Media

Asia Pacific: [www.hp.com/apac/printingsupplies](http://www.hp.com/apac/printingsupplies)  
Asia: 65-6253-8500  
Australia and New Zealand: 61-2997-2299LAR

#### Print servers

J7960G	HP Jeldirect 625n Gigabit internal print server (EIO)
J7961G	HP Jeldirect 635n IPv6/IPv4 and Gigabit Ethernet internal print server (EIO)
J7942G	HP Jeldirect en3700 Fast Ethernet external print server (USB 2.0)
J6035G	HP Jeldirect 175x Fast Ethernet external print server (USB 1.1)

#### Memory and storage

J6073G	HP high-performance EIO hard disk
Q7713A	32 MB 100-pin DDR DIMM
Q7715A	64 MB 100-Pin DDR DIMM
Q7718A	128 MB 100-Pin DDR DIMM
Q7719A	256 MB 100-Pin DDR DIMM
Q7720A	512 MB 100-Pin DDR DIMM

#### Cables

C6518A	USB, 2-meter A to B cable
C2950A	Parallel cable, 2-meter IEEE 1284-B
C2951A	Parallel cable, 3-meter IEEE 1284-B

#### Service and support

U3472PE	HP 1 year, post-warranty, next business day hardware support
U6397PE	HP 1 year, post-warranty, 4 hour hardware support (9 x 5)
U3511PE	HP 1 year, post-warranty, 4 hour hardware support (13 x 5)
UC741E	HP installation service
UC742E	HP network installation service
HC128PE	HP 1 year, phone assist hardware support
U3469E	HP 3 years, next business day hardware support
U3468E	HP 3 years, return service
U4665E	HP 3 years, 4 hour hardware support (9 x 5)
U3470E	HP 3 years, 4 hour hardware support (13 x 5)
U6407E	HP 4 year, next business day hardware support
UA193E	HP 4 year, 4 hour hardware support (9 x 5)
UA191E	HP 4 year, 4 hour hardware support (13 x 5)
U6408E	HP 5 year, next business day hardware support
UA194E	HP 5 year, 4 hour hardware support (9 x 5)
UA192E	HP 5 year, 4 hour hardware support (13 x 5)



## HP LaserJet 5200 printer series

Powerful, efficient and manageable wide-format laser printing for business workgroups



<sup>1</sup> Exact speed depends on system configuration, software programs and document complexity.

<sup>2</sup> Available with HP LaserJet 5200n, 5200tn and 5200dn printers only.



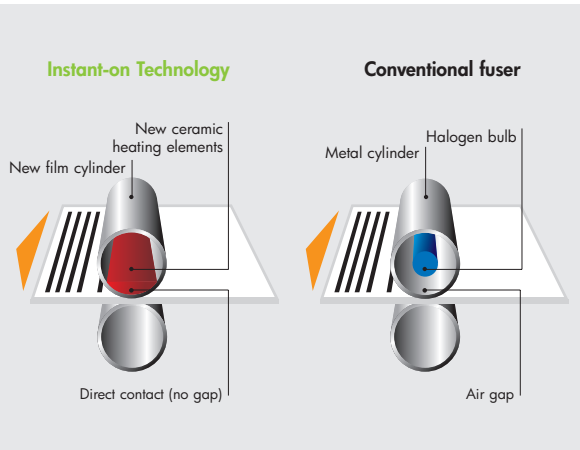

Instant-on Technology enables fast first page out from PowerSave mode

Network up to 10 users

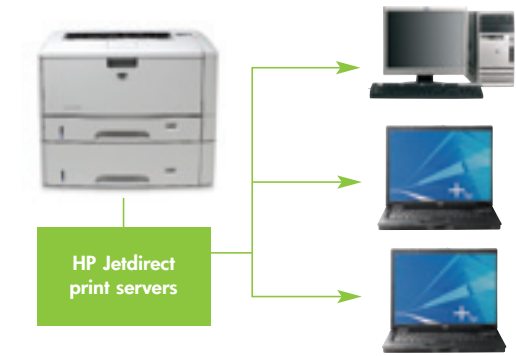

Share your printer with multiple users

With direct PDF printing



Direct PDF is convenient and simple



Replace and install supplies easily with HP all-in-one print cartridge



Full toner right out of the box, prints up to 12,000 pages<sup>2</sup>

Get more done—less waiting for print jobs

- Print at speeds of up to 35 ppm (letter and A4) or 18.5 ppm (tabloid and A3)
- Start printing fast from PowerSave mode, in less than 10 seconds with Instant-on Technology
- Process complex jobs easily with a 460 MHz processor and expandable memory up to 512 MB RAM
- RIP ONCE allows multiple copies to be printed from memory, without the need to process data for every single copy

Enhance productivity—easy networkability

- Allow printing for a workgroup of 2 to 10 users
- HP Jetdirect en3700 Fast Ethernet external print server<sup>1</sup>
- EIO slot for optional HP Jetdirect internal print server
- Hi-Speed USB 2.0 and parallel ports support direct PC connection and optional HP Jetdirect external print servers

Create impressive collateral—professional quality printing

- Clear, sharp text, smooth greyscales and deep blacks
- HP ProRes1200 technology prints True 1200 x 1200 dpi at full engine speed

Grow with your business needs—expandable features

- Two CompactFlash slots dedicated to third party solutions enable more fonts, barcode printing, secure check printing, PDF direct printing, job accounting, intelligent e-forms and SAP/ERP solutions
- The open EIO slot allows productivity upgrades such as IPv6/IPsec Gigabit or HP high-performance hard disks
- Expand maximum input capacity with the optional 500-sheet input tray, to minimise user intervention
- Optional two-sided printing further enhances unattended printing and enables creation of professional collateral

Choose media flexibility—versatile paper handling

- Wide format printing, up A3+ size, can produce marketing proofs, architectural plans or financial ledgers and spreadsheets
- Print on envelopes, labels, transparencies, letterhead, pre-punched paper, coloured paper, rough paper and card stock

Concentrate on business—manage, monitor and use effortlessly

- Intuitive control panel lets you check status, print jobs and problems
- HP Easy Printer Care Software allows easy management of up to 15 printers, or use HP Web Jetadmin for larger IT environments
- Direct PDF printing allows printing of PDF files directly from any device, without needing print drivers
- Supports PCL6 and Postscript level 3, with automatic language switching
- Included HP All-in-One print cartridge, with HP Smart Printing technology, is easily installed and can print 12,000 pages<sup>2</sup>, right out of the box

<sup>1</sup> Available with HP LaserJet 5200n, 5200tn and 5200dtn printers only.  
<sup>2</sup> Based on 5 percent page coverage.



HP's award-winning reliability<sup>1</sup>

HP LaserJet 5200 printer series

1. 250-sheet output bin
2. Adjustable 100-sheet multipurpose tray for special media, including tabloid/A3+ sizes
3. 250-sheet input tray 2, up to tabloid/A3 sizes
4. 500-sheet input tray 3, up to tabloid/A3 sizes
5. 128 MB of standard printing memory and a powerful 460 MHz processor
6. One open EIO slot
7. HP Jetdirect en3700 Fast Ethernet external print server
8. IEEE 1284 parallel port
9. Hi-Speed USB 2.0 port
10. Intuitive control panel displays two lines of text
11. Automatic two-sided printing unit increases efficiency



Front view



Back view

HP LaserJet 5200dtn Printer shown

Accessories

**500-sheet input tray (Q7548A)**  
Expand the input capacity of the HP LaserJet 5200 and 5200n printers to a maximum of 850 sheets, by installing the optional 500-sheet tray 3 (standard on 5200tn and 5200dtn models).

**Automatic two-sided printing unit (J7942A)**  
Print professional documents and save time with the automatic two-sided printing unit (standard on the 5200dtn model).

**HP Jetdirect internal print server (J7934G)**  
Increase efficiency and security by installing the HP Jetdirect 635n IPv6/IPsec and Gigabit Ethernet internal print server in the available EIO slot.

**HP Jetdirect external print server (J7942G)**  
Enable Fast Ethernet connectivity with the HP Jetdirect en3700 Fast Ethernet external print server connected via Hi-Speed USB port.





**HP high-performance EIO hard disk (J6073G)**  
Maximize the printer's flexibility by installing the HP high performance EIO hard disk.

**Additional memory (Q7720A)**  
Get up to 512 MB RAM via one DIMM slot.

Renowned HP LaserJet quality and reliability

- HP is undisputed leader in providing reliable printing solutions for over 20 years
- Awarded by PC Magazine's Service and Reliability Survey, September 2005
  - An "A" rating for 12 years in a row
  - An "A+" rating for 2 years running
  - Clinched top spot for 14 consecutive years

<sup>1</sup> 20 September 2005, PC Magazine's 18th Annual Reader Satisfaction survey.

HP LaserJet 5200 printer series	HP LaserJet 5200 Printer (Q7543A)	HP LaserJet 5200n Printer (Q7544A)	HP LaserJet 5200tn Printer (Q7545A)	HP LaserJet 5200dtn Printer (Q7546A)
Technical specifications	   			
Print speed	Up to 35 ppm, letter and A4; up to 18.5 ppm, tabloid/A3			
First page out <sup>1</sup> (from ready)	Less than 10 seconds letter and A4			
Resolution	FastRes 1200 and ProRes 1200 (1200 x 1200 dpi)			
Processor	460 MHz			
Memory	48 MB RAM, one open DIMM slot	64 MB RAM, one open DIMM slot		128 MB RAM
Memory, maximum	Up to 512 MB RAM via a single industry-standard 100-pin DDR DIMM slot			
Compact flash	Two open industry-standard Compact Flash slots			
Hard disk	Optional HP high-performance EIO hard disk (20 GB)			
Monthly duty cycle	Up to 65,000 pages per month			
Media				
Input	100-sheet multipurpose tray 1, 250-sheet input tray 2, optional 500-sheet input tray 3		100-sheet multipurpose tray 1, 250-sheet input tray 2, 500-sheet input tray 3	
Output	250-sheet output bin			
Duplex printing	Optional automatic two-sided printing unit			
Sizes	Multipurpose tray 1: 76.2 x 127 mm to 312 x 470 mm (3 x 5 inches to 12.28 x 18.5 inches); letter, letter rotated, legal, executive, statement, 8.5 x 13, 11 x 17, 12 x 18, A3, A4, A4 rotated, A5, A6, RA3, B6 (JIS), B5 (JIS), B4 (JIS), executive (JIS), postcard (JIS), DPostcard (JIS), 8 K, 16 K, envelopes (Monarch, C5, DL, B5, #10), custom 250-sheet tray 2, 500-sheet tray 3: 76.2 x 127 mm to 297 x 431.8 mm (3 x 5 inch to 11.69 x 17 inches); letter, letter rotated, legal, executive, statement, 8.5 x 13, 11 x 17, A3, A4, A4 rotated, A5, B5, B4, executive (JIS) 8 K, 16 K, custom; Automatic two-sided printing unit: letter, letter rotated, legal, executive, 8.5 x 13, 11 x 17, A3, A4, A4 rotated, A5, B5, B4, 8 K, 16 K, custom			
Weight	Multipurpose tray 1: 60 to 199 g/m <sup>2</sup> (16 to 53 lb); 250-sheet tray 2, 500-sheet tray 3, automatic two-sided printing unit: 60 to 120 g/m <sup>2</sup> (16 to 32 lb)			
Types	Paper (plain, preprinted, letterhead, prepunched, bond, recycled, colour, rough, light, vellum, tough), transparencies, labels, envelopes, cardstock			
Connectivity				
Interfaces	Hi-Speed USB 2.0 port, IEEE 1284 parallel port, one open EIO slot	Hi-Speed USB 2.0 port, IEEE 1284 parallel port, one open EIO slot, HP Jetdirect Fast Ethernet embedded print server		
Languages	HP PCL 6, HP PCL 5e, HP postscript level 3 emulation, 103 built-in scalable PCL fonts, 93 internal PostScript® fonts			
Client operating systems	Microsoft® Windows® 98, Me, 2000, XP, Server 2003; Mac OS X-10.2, 10.3, 10.4			
Networking operating systems	—	Via embedded print server: Microsoft® Windows 98, 2000, XP, Server 2003; NetWare; UNIX®; AppleTalk; linux®; HP-UX; LocalTalk		
Dimension (w x d x h)	490 x 563 x 275 mm (19.3 x 22.2 x 10.8 inches)		490 x 600 x 405 mm (19.3 x 23.6 x 15.9 inches)	
Weight	20.2 kg (44.5 lb)		30.2 kg (66.5 lb)	33.1 kg (73 lb)
What's in the box	5200 printer, HP LaserJet Q7516A Black Print Cartridge with Smart Printing Technology, documentation (Getting Started Guide), software and documentation CD, power cord, control panel overlay, 100-sheet multipurpose tray 1, 250-sheet input tray 2	5200n printer, HP LaserJet Q7516A Black Print Cartridge with Smart Printing Technology, documentation (Getting Started Guide, Network Install Guide), software and documentation CD, power cord, control panel overlay, 100-sheet multipurpose tray 1, 250-sheet input tray 2	5200tn printer, HP LaserJet Q7516A Black Print Cartridge with Smart Printing Technology, documentation (Getting Started Guide, Network Install Guide), software and documentation CD, power cord, control panel overlay, 100-sheet multipurpose tray 1, 250-sheet input tray 2, 500-sheet input tray 3	5200dtn printer, HP LaserJet Q7516A Black Print Cartridge with Smart Printing Technology, documentation (Getting Started Guide, Network Install Guide), software and documentation CD, power cord, control panel overlay, 100-sheet multipurpose tray 1, 250-sheet input tray 2, 500-sheet input tray 3, automatic two-sided printing unit
Operating environment				
Operating environment	50 – 91°F (10 – 32°C)			
Storage temperature	32 – 104°F (0 – 40°C)			
Relative humidity	20 – 80%, non-condensing			
Acoustics <sup>2</sup>				
Sound power	Printing: 6.84 B(A); Standby: 4.6 B(A)			
Bystander sound pressure	Printing: 54 dB(A); Standby: 31 dB(A)			
Power specifications <sup>3</sup>	110-volt models: 110 to 127 V (± 10%), 50/60 Hz (± 2 Hz) 220-volt models: 220 to 240 V (± 10%), 50/60 Hz (± 2 Hz)			
Power consumption				
(Energy Star® compliant)				
Printing	550 watts (5200n, 5200tn, 5200dtn: 600 watts)			
Standby	27 watts			
PowerSafe	7 watts (5200n, 5200tn, 5200dtn: 7.5 watts)			
Off	27 watts			

<sup>1</sup> Exact speed varies depending on the system configuration, software program, document complexity, network, media width, media weight, environment and job size.  
<sup>2</sup> Base model using A4 paper printing simplex at 35 ppm.  
<sup>3</sup> Values subject to change, see [www.hp.com/support/lj5200](http://www.hp.com/support/lj5200) for current information.